

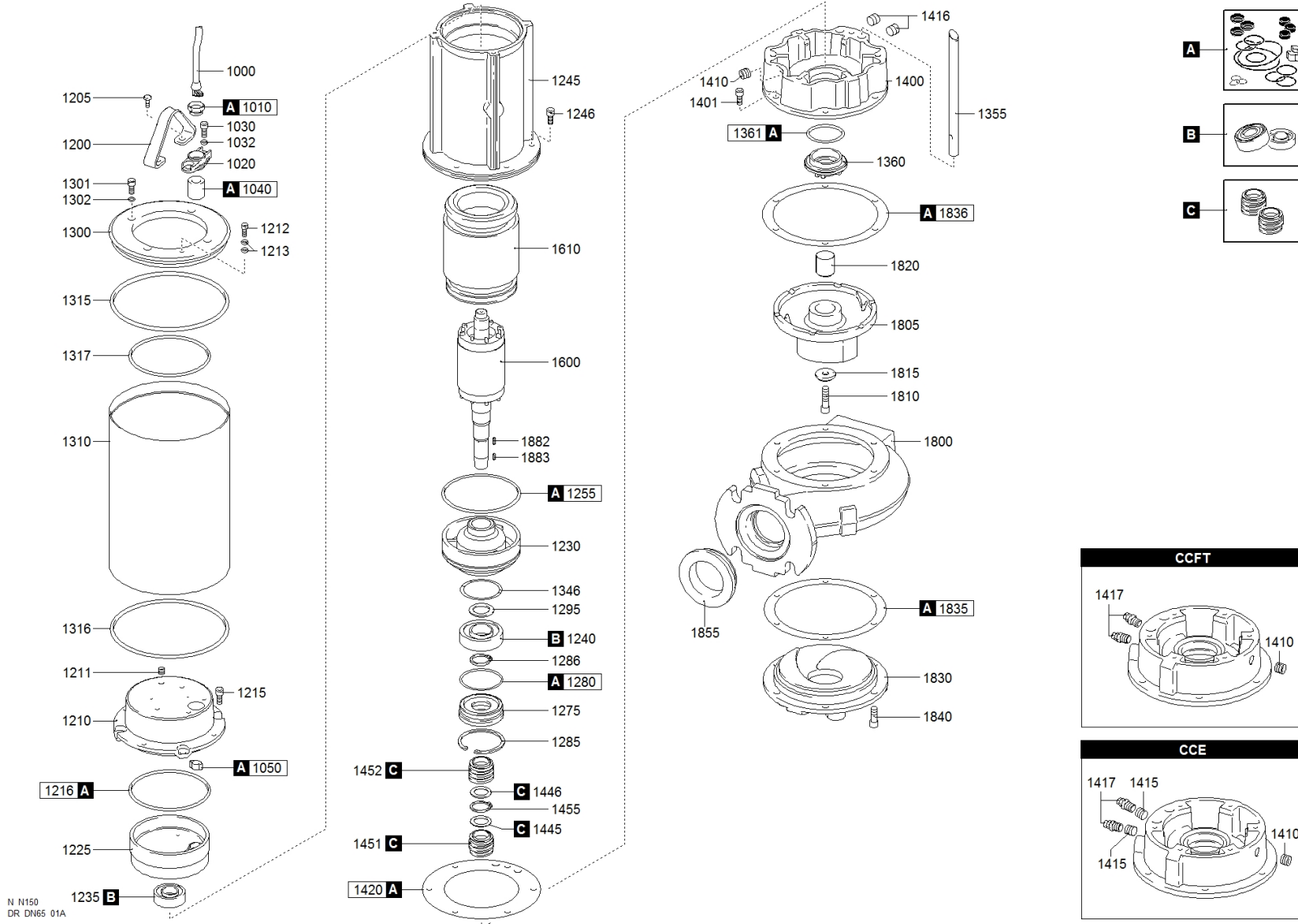

water solutions

0811.002 - DRN 550/2/65 A1FT5 NGTAB51040S00EX





water solutions



0811.002 - DRN 550/2/65 A1FT5 NGTAB51040S00EX

		Code		Description		Q.ty	Price (€)
A		601012001		GASKETS KIT	711078	1	
C		602010101		MECHANICAL SEALS KIT	802268	1	
B		604012001		BEARINGS KIT	805516	1	
1000		25020340251000001		POWER CABLE	802307	1	
1010		235467216820		RING NUT [POWER CABLE]	711016 OR 802074	1	
1020		235424018990		CABLE GLAND [POWER CABLE]	711014	1	
1030		270830810203200000		SCREW - CABLE GLAND [POWER CABLE]	802093 OR 802095	2	
1032		270530604152000000		WASHER - CABLE GLAND [POWER CABLE]	802314	2	
1040		235673224119		RUBBER GASKET [POWER CABLE]	802277	1	
1050		2732001600000		COLLAR CLAMP [POWER CABLE]	802280	1	
1200		235232418750		HANDLE	802275	1	
1205		270830810161200000		SCREW [HANDLE >> COVER]	802317	2	
1209		270530604152000000		WASHER [HANDLE >> COVER]	802314	2	
1210		232115118950		COVER	802274	1	
1211		270139510104000000		CAP [TIGHTNESS TEST]	802099	1	
1212		270830810123200000		SCREW [GROUND CABLE]	802316	1	
1213		270530604152000000		WASHER [GROUND CABLE]	802314	2	
1215		270831010253200000		SCREW [COVER >> MOTOR CASE]	802320	4	
1216		271770148035100000		GASKET [COVER >> MOTOR CASE]	802324	1	
1225		230615118930		UPPER BEARING HOLDER	802272	1	
1230		230515123369		LOWER BEARING HOLDER	802271	1	
1235		2729063050400000		UPPER BEARING	710969	1	
1240		2729063070200000		LOWER BEARING	802297	1	
1245		231015123166		MOTOR CASE	710996	1	
1246		270830810303200000		SCREW [MOTOR CASE >> OIL CHAMBER]	802091	6	
1255		271770142035100000		GASKET [MOTOR CASE >> LOWER BEARING HOLDER]	802323	1	
1275		2391080039019000		LOWER BEARING FLANGE	802291	1	
1280		271770073035100000		GASKET [LOWER BEARING FLANGE]	802321	1	
1285		2703208802000000		SEEGER [LOWER BEARING FLANGE >> MECHANICAL SEAL]	802289	1	
1286		2703303501000000		SEEGER [LOWER BEARING >> LOWER BEARING FLANGE]	802290	1	
1295		270220350452500000		UPPER DISTANCE RING [LOWER BEARING]	802312	1	
1301		270830810203200000		SCREW - STOP RING [COOLING JACKET]	802093 OR 802095	4	
1346		275420790000000		WAVE SPRING	802284	1	
1360		2307103023309		BUSH [OIL CHAMBER]	711111	1	
1361		271770065035100000		GASKET - BUSH [OIL CHAMBER]	802106	1	
1400		238611603023301		OIL CHAMBER	802288	1	
1401		270830810203200000		SCREW [OIL CHAMBER >> PUMP BODY]	802093 OR 802095	6	
1410		270139530104000000		CAP [OIL CHAMBER]	802100	1	

1416	270139530104000000	EXTERNAL CAP [FLUSHING CHANNEL]	802100	2
1420	2750914219680	GASKET [LOWER BEARING HOLDER >> OIL CHAMBER]		1
1445	270542221609011370	WASHER [1st MECHANICAL SEAL]		1
1446	270542221609011370	WASHER [2nd MECHANICAL SEAL]		1
1451	230001810300000000	1st MECHANICAL SEAL		1
1452	230001810300000000	2nd MECHANICAL SEAL		1
1455	270330300100000	SEEGER [1st MECHANICAL SEAL >> 2nd MECHANICAL SEAL]	802102	1
1600	230232612823319	SHAFT WITH ROTOR	802286	1
1610	231101283001000000	WOUND STATOR	710997	1
1650	2790360424886	DATAPLATE	802080	1
1655	273130000000	RIVET [DATAPLATE]	802085	2
1800	21251016025523421	PUMP BODY	802064	1
1805	21411001400723709	IMPELLER		1
1810	270831010403200000	LOCKING IMPELLER		1
1815	270530916939023322	LOCKING WASHER [IMPELLER]		1
1820	2307403223323	BUSH [IMPELLER]	801012	1
1830	2162117023189	SUCTION FLANGE		1
1835	2750917023063	GASKET [PUMP BODY >> SUCTION FLANGE]		1
1836	2750916023613	GASKET [OIL CHAMBER >> PUMP PLATE]	710955 OR 802282	2
1840	270830810203200000	SCREW [SUCTION FLANGE >> PUMP BODY]	802093 OR 802095	6
1855	2750725403390	DISCHARGE GASKET	802079 OR 805897	1